

KEY FEATURES

- 344 × 288 Resolution (Thermal), and 4 MP Resolution (Optical)
- Thermographic Accuracy
±0.9° F (±0.5° C) w/o Blackbody
±0.5° F (±0.3° C) with Blackbody
- Display Fusion of Thermal View and Optical View
- Supports Live View on PC or External Monitor
- Supports Audio Intercom
- Supports Color Highlight Alarm and Audio Alarm

APPLICATIONS

- Set Up Screening Checkpoints
- Perform Preliminary Screening
- Perform Secondary Check

BENEFITS

- Non-contact Measurement to Avoid Physical Contact
- One Second Per Person for Skin-Surface Temperature Detection
- AI Detection, Greatly Reducing False Alarms

The Long-Range Thermal Screening Bundle allows for skin-surface temperature detection that is rapid for safe preliminary screening in public areas. The bundled Bullet Camera's 384 x 288 high sensitivity sensor features adaptive AGC (Automatic Gain Control), 3D DNR (Digital Noise Reduction), and Digital Detail Enhancement for outstanding image enhancement. The 4 MP optical sensor provides outstanding color video in very dim environments down to 0.0089 lux, and built-in IR illumination allows black and white optical surveillance in zero-light conditions up to 164 ft (50 m). This thermal screening bundle is able to measure an object's temperature at a high accuracy in real time. It is suitable for use in areas that require greater security measures such as airports.

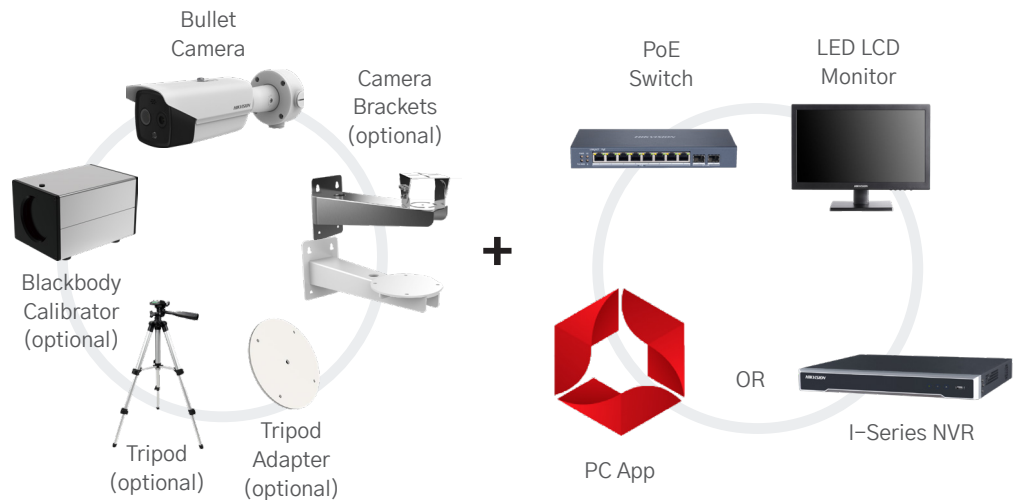

Thermal Module

Image Sensor	Uncooled focal plane arrays
Resolution	384 × 288
Pixel Pitch	17 μm
Response Waveband	8 μm to 14 μm
NETD	<35 mk (@ 25° C, F#=1.0)
Field of View	28.8° × 21.6° (H × V)
Focal Length	13 mm
IFOV	1.13 mrad
Min. Focusing Distance	1.6 ft (0.5 m)
Aperture	f/1.0

Image Function

Bi-Spectrum	Display optical channel
Image Fusion	Display optical channel details on thermal channel
Picture-in-Picture	Display partial image of thermal channel on full screen of optical channel

Integration

RJ-45	x1
RS-485	x1
SD Card Slot	x1
Reset Button	x1

Optical Module

Max Image Resolution	2688 × 1520
Image Sensor	1/2.7" progressive scan CMOS
Shutter Speed	1 s to 1/100,000 s
Lens (Focal Length)	6 mm
Field of View	51.7° × 28° (H × V)
WDR	120 dB
Day/Night Mode	IR cut filter with auto switch
Minimum Illumination	Color: 0.0089 lux (f/1.6, AGC on), B/W: 0.0018 lux (f/1.6, AGC on)

General

Power	24 VAC ±25%, 12 VDC ±25%, two-core terminal block, PoE (802.3af, class 3)
Power Consumption	Maximum 9.5W
Protection Level	IP66 Standard
Working Temperature*	50° to 95° F (10° to 35° C)
*indoor and windless environment use only	
Dimensions	14.81" × 4.68" × 4.65"
Weight	4.01lbs